



RAFFLES GIRLS' PRIMARY SCHOOL

SEMESTRAL ASSESSMENT 2 2011

Your Score Out of 100 marks		
	Class	Level
Highest score		
Average score		
Parent's Signature		

Name : _____ () Class: P4__

24 OCT 2011 MATHEMATICS Att: 1 h 45 min

SECTION A (25 marks)

Questions 1 to 5 carry 1 mark each. Question 6 to 15 carry 2 marks each. For each question, four options are given. One of them is the correct answer. Make your choice (1, 2, 3 or 4). Shade your answer (1, 2, 3 or 4) on the OAS provided.

1. The value of the digit 7 in 72 845 is _____.

- (1) 70
- (2) 700
- (3) 7000
- (4) 70000

()

2. 68 547 when rounded off to the nearest hundred is _____.

- (1) 68 000
- (2) 68 500
- (3) 68 600
- (4) 69 000

()

3. The area of a square is 64 cm^2 . Find the length of each side of the square.

- (1) 8 cm
- (2) 16 cm
- (3) 32 cm
- (4) 256 cm

()

4. Jovina left her house at 8.40a.m. for the market. She took 35 minutes to walk to the market. What time did she reach the market?

- (1) 8.05 a.m.
- (2) 8.10 a.m.
- (3) 9.10 a.m.
- (4) 9.15 a.m.

()

5. The table below shows the mass of 4 children.
Study it carefully and answer the question.

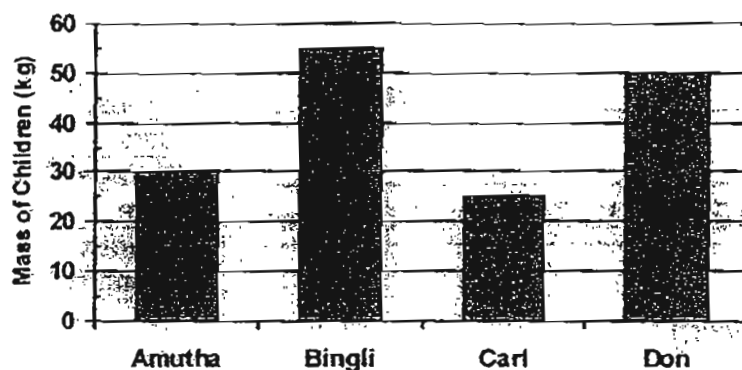

Find the difference in mass between the lightest child and the heaviest child.

- (1) 15kg
(2) 20kg
(3) 25kg
(4) 30kg

()

6. Express 0.08 as a fraction in its simplest form.

- (1) $\frac{2}{25}$
(2) $\frac{4}{5}$
(3) $\frac{1}{10}$
(4) $\frac{1}{8}$

()

7. Which of the following fractions is in its simplest form?

- (1) $\frac{3}{5}$
(2) $\frac{4}{8}$
(3) $\frac{6}{9}$
(4) $\frac{3}{15}$

()

8. Which of the following figures contains both parallel lines and perpendicular lines?

(1)

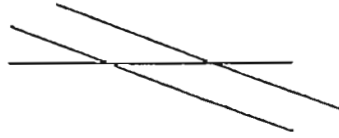

(2)

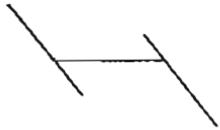

(3)

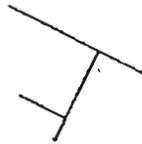

(4)

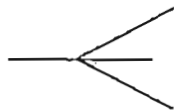

()

9. $4\frac{5}{6} = \frac{\boxed{}}{6}$

What is the missing number in the box?

(1) 15

(2) 20

(3) 24

(4) 29

()

10. $8.09 = 8 + \frac{9}{\boxed{}}$

What is the missing number in the box?

(1) 1

(2) 10

(3) 100

(4) 1000

()

11. In which of the following are the numbers arranged from the smallest to the greatest?

- (smallest) (greatest)
- (1) 8790, 8709, 8079
- (2) 8079, 8790, 8709
- (3) 8790, 8709, 8079
- (4) 8079, 8709, 8790

()

12. Christina has \$45.65. She has \$2.30 less than Suresh. How much do they have altogether?

- (1) \$43.35
- (2) \$47.95
- (3) \$89.00
- (4) \$93.60

()

13. Figure Z is made up of a rectangle X and a square Y of sides 4 cm. The length of rectangle X is the same as the perimeter of square Y. The breadth of rectangle X is 4 cm. Find the perimeter of figure Z.

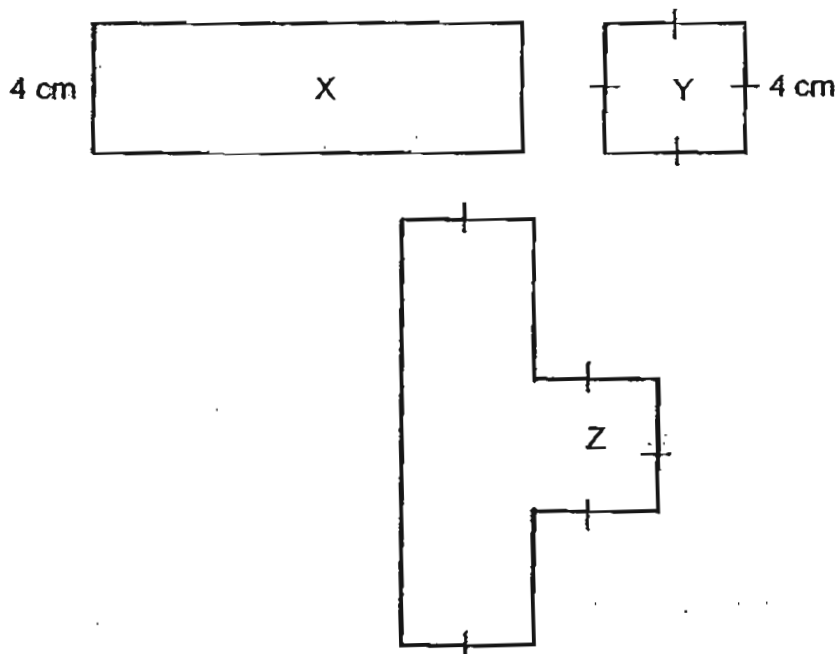

- (1) 32 cm
- (2) 44 cm
- (3) 48 cm
- (4) 56 cm

()

14. The table below shows the number of girls taking part in different CCA in a school. Each girl took part in only one CCA.

CCA	Number of girls
Swimming	82
Badminton	70
Basketball	92
Tennis	36

$\frac{1}{4}$ of the total number of girls took part in _____.

- (1) Swimming
(2) Badminton
(3) Basketball
(4) Tennis

()

15. Eight pots of flowers are placed at equal distance of 1m 40 cm from each other as shown in the diagram below. What is the total distance from the first and the last pot of flower?

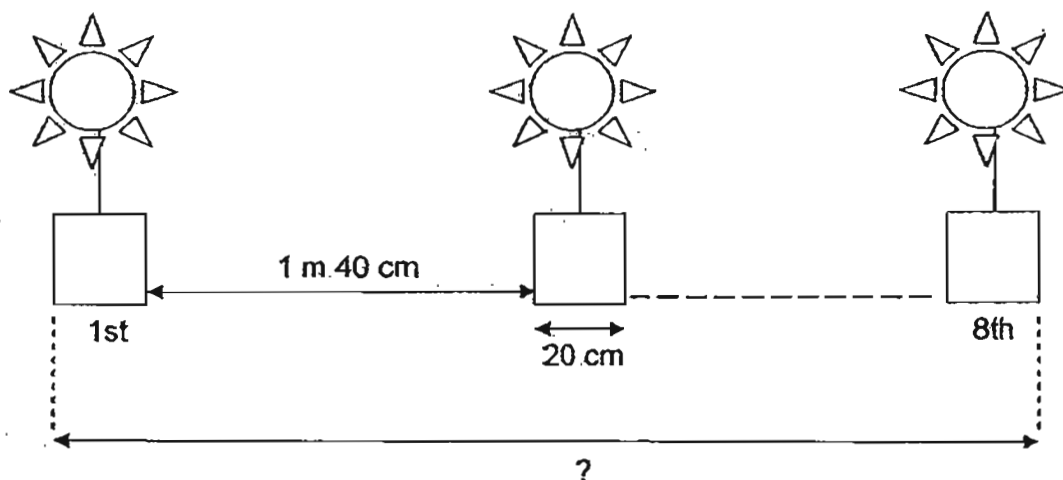

- (1) 980 cm
(2) 1120 cm
(3) 1140 cm
(4) 1280 cm

()

SECTION B (40 marks)

Question 16 to 35 carry 2 marks each. Write your answers in the spaces provided. For questions which require units, give your answers in the units stated. All diagrams are not drawn to scale. Answers in fractions must be expressed in the simplest form. Marks will be awarded for relevant working.

16. Fill in the blank with the correct number in the number pattern below.

54, 68, 82, _____, 110

Ans: _____

17. The figure is made up of nine identical rectangles each measuring 4cm by 2cm. Find the perimeter of the figure.

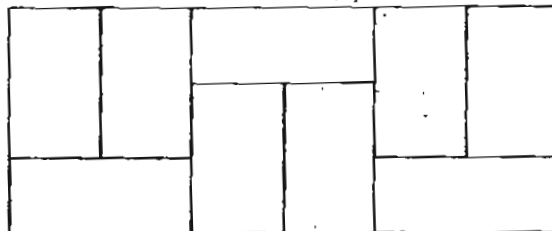

Ans: _____ cm

18. The bar graph below shows the number of pupils who passed the Physical Fitness Test this year in four classes.

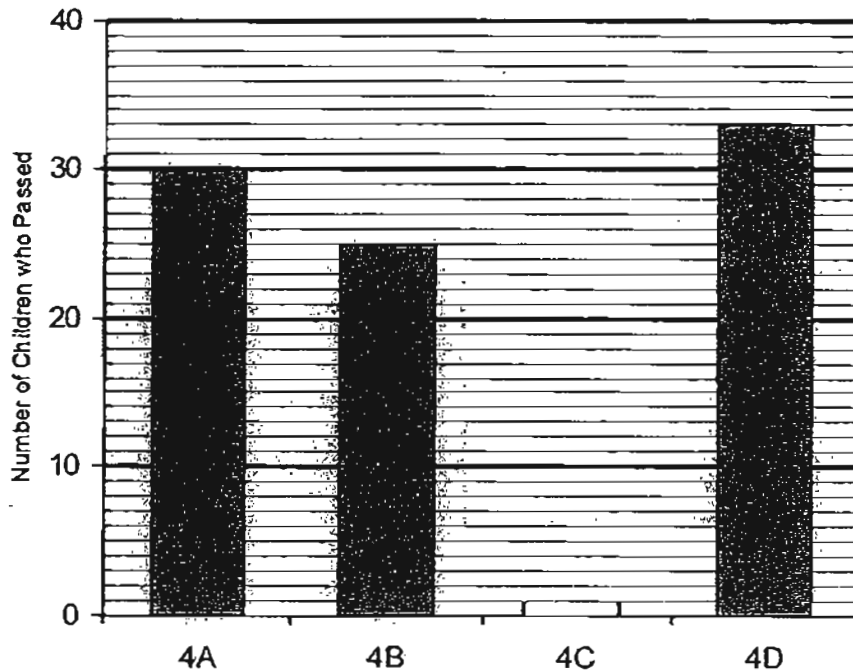

A total of 108 pupils in the four classes passed the Physical Fitness Test. Complete the bar graph above to show the number of pupils in Primary 4C who had passed the test.

19. 6 identical tennis balls have a total mass of 54 g.
3 identical ping pong balls have a total mass of 12 g.
What is the total mass of 8 such tennis balls and 3 such ping pong balls?

Ans: _____ g

22. Arrange the following fractions from the smallest to the greatest.

$$\frac{3}{4}, \quad \frac{3}{8}, \quad \frac{5}{8}$$

Ans: _____, _____, _____
(smallest) (greatest)

23. Arrange the following numbers in order from the greatest to the smallest.

0.023, 0.302, 0.203

Ans: _____, _____, _____
(greatest) (smallest)

24. A straight line AB is drawn on the square grids as shown below.

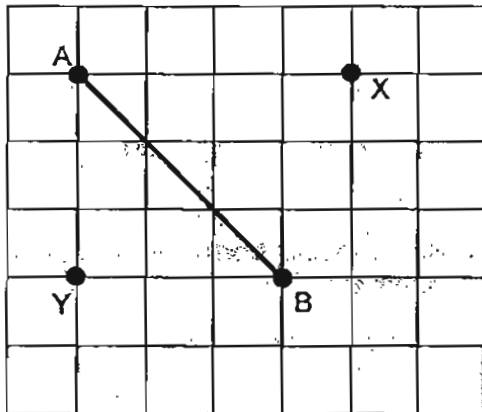

- (a) Draw a line perpendicular to AB passing through point X.
(b) Draw a line parallel to AB passing through point Y.

25. $\frac{1}{3} - \frac{2}{9} =$ _____

Ans: _____

26. $6568 \div 8 =$ _____

Ans: _____

27. Two factors of 21 are 1 and 21. What are the other two factors of 21?

Ans: _____ and _____

28. The table below shows the number of books the pupils borrowed in August. How many books did the pupils borrow altogether?

Number of books borrowed	0	1	2
Number of pupils	5	16	19

Ans: _____

29. Object A weighs 1 kg 500 g.
The mass of object B is four times the mass of object A.
Find the mass of object B.

Ans: _____ g

30. Tammy takes 1 hour 10 minutes to reach home from work by cycling. If she takes a bus, she could reach home in $\frac{1}{5}$ of the time taken by cycling. How much longer is her travelling time by cycling?

Ans: _____ min

31. Measure and write down the size of $\angle x$.

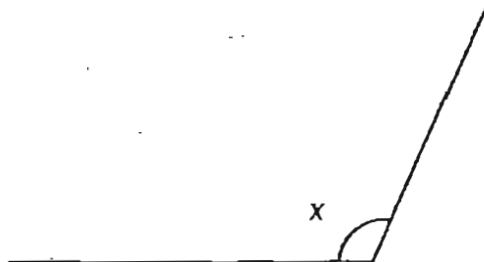

Ans: _____ °

32. Extend the tessellation by drawing 2 more unit shapes.

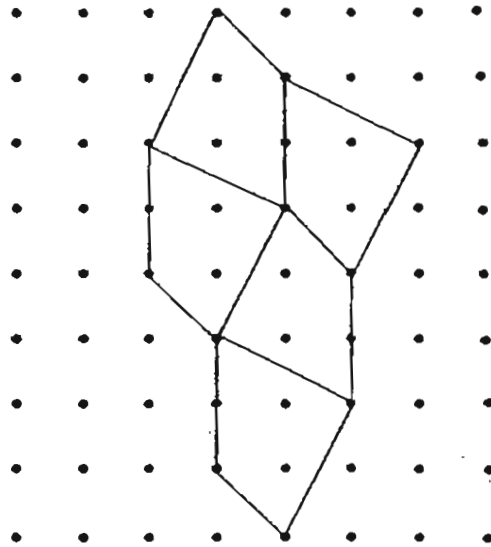

33. Find the value of 6.27×8 .

Ans: _____

34. Subtract 493 from 872.

Ans: _____

35. Meng Meng had enough money to buy 20 oranges only. She bought 14 oranges and had \$2.70 left. How much money did she have at first?

Ans: \$ _____

SECTION C (35 marks)

For question 36 to 44, show your working clearly in the space provided below each question and write your answer with suitable units in the spaces provided. All diagrams are not drawn to scale. Answers in fractions must be expressed in the simplest form. Marks will be awarded for relevant working. The number of marks available is shown in brackets [] at the end of each question or part-question.

36. Mei Ying and Rashid had 70 pencils altogether. When Mei Ying gave 8 of her pencils to Rashid, Rashid had 6 times as many pencils as Mei Ying. How many pencils did Rashid have at first?

Ans: _____ [3]

37. The graph below shows the income Mr Walla made as a salesman from March to July.

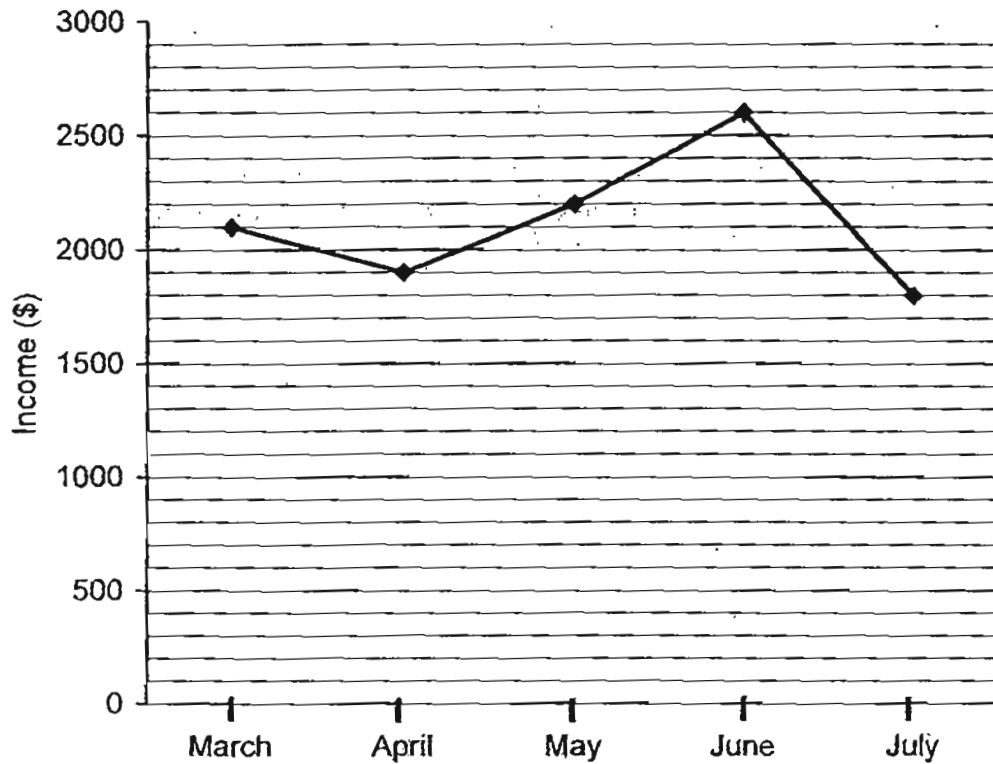

- a) What was the difference between the highest and lowest income earned by Mr Walla?

Ans: (a) _____ [2]

- (b) Between which two months was the decrease in Mr Walla's income the greatest?

Ans: (b) _____ and _____ [1]

38. 3 pails and 2 tanks can hold a total of 54.9 ℓ of milk. A tank can hold 3 times as much milk as a pail. How much milk can a tank and 4 pails hold altogether?

Ans: _____ [3]

39. VWXY is a rectangle of length 30 cm and breadth 14 cm. Z is the mid-point of VW. Find the area of the shaded part of the rectangle.

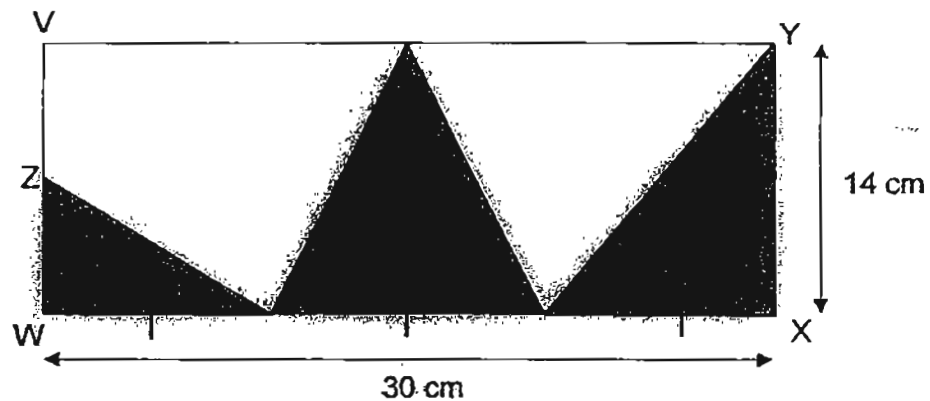

Ans: _____ [4]

40. Kelly and Alex were given some allowance at first.

Kelly spent $\frac{1}{4}$ of her allowance and had \$360 left.

Alex spent three times as much as Kelly and had $\frac{1}{2}$ of his allowance left.

(a) How much allowance did Kelly have at first?

(b) How much more allowance did Alex have than Kelly?

Ans: (a) _____ [3]

(b) _____ [1]

41. Mrs Tan had a sum of money. At the Great Singapore Sale, She spent $\frac{1}{4}$ of her money on 5 pairs of shoes of the same price and half of the remainder on an oven. She then spent \$52.30 on clothes and had \$88.70 left. What was the price of each pair of shoes?

Ans: _____ [4]

42. The diagram below shows the mass of two identical boxes with objects P and Q placed in them respectively.

(a) Given that object Q is three times as heavy as object P, find the mass of object Q.

(b) Find the mass of an empty box. Express your answer in grams.

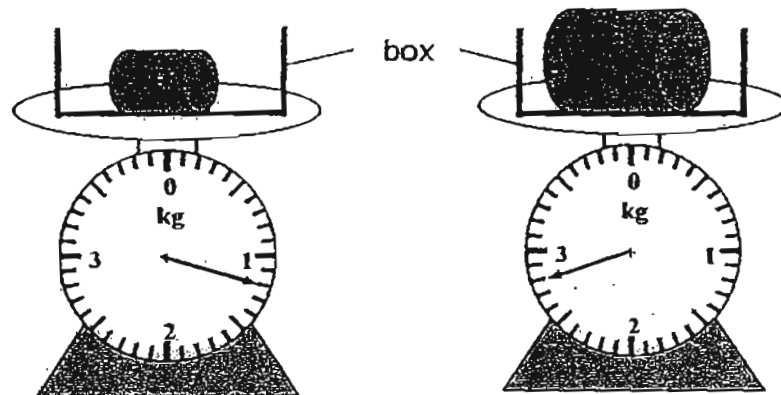

Ans: (a) _____ [3]

(b) _____ [1]

43. Sammy has \$60 and Timothy has \$40 in their bank account. Everyday, Sammy deposits \$5 while Timothy deposits \$9.

(a) How long does it take for Sammy and Timothy to have the same amount of money in their account?

(b) How many days will Timothy need to save in order to have \$40 more than Sammy?

Ans: (a) _____ [3]

(b) _____ [2]

44. Mrs Gopal had some \$2, \$5 and \$10 notes in her purse. The number of \$5 notes was $\frac{1}{3}$ the number of \$2 notes. The number of \$10 notes was $\frac{1}{2}$ the number of \$2 notes. After spending all her \$10 notes and $\frac{2}{3}$ of her \$2 notes, she had \$210 left in her purse. How much money did she spend altogether?

Ans: _____ [5]

-End of Paper-
Please check your work carefully ☺

Setters: Chong Jie Qi & Yeo Melissa

Answer Ke

EXAM PAPER 2011

SCHOOL : RAFFLES GIRLS'
SUBJECT : PRIMARY 4 MATHEAMATICS

TERM : SA2

Q1	Q2	Q3	Q4	Q5	Q6	Q7	Q8	Q9	Q10	Q11	Q12	Q13	Q14	Q15
4	2	1	4	4	1	1	3	4	3	4	4	4	2	1

16)96

17)36cm

18)draw to 20

19)84g

20)

21)

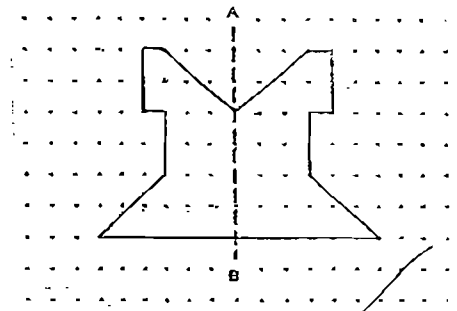
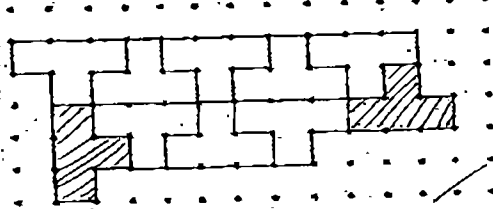

22) $\frac{3}{8}$, $\frac{5}{8}$, $\frac{3}{4}$

23)0.302, 0.203, 0.023

24)

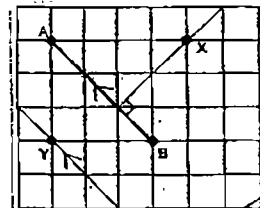

25) $\frac{1}{9}$

26)821

27)3 and 7

28)54 books

29)6000g

30)56min

31) 115°

32)

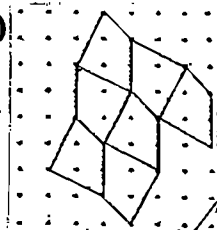

33)50.16

34)379

35)\$9.00

36) $70 \div 7 = 10$

$10 \times 6 = 60$

$60 - 8 = 52$

Rashid had 52 pencils at first.

37)a)\$800

b)June and July

38) $54.9 \div 9 = 6.1$

$6.1 \times 3 = 18.3$

$6.1 \times 4 = 24.4$

$24.4 + 18.3 = 42.7$

A tank and 4 pails can hold 42.7L of milk.

39) $30 \div 3 = 10$

$10 \times 7 = 70$

$70 \div 2 = 35$

$20 \times 14 = 280$

$280 \div 2 = 140$

$35 + 140 = 175$

The area of the shaded part is 175cm²

40)a) $360 \div 3 = 120$

$120 \times 4 = 480$

Kelly had \$480 at first.

b) $120 \times 3 = 360$

$360 \times 2 = 720$

$720 - 480 = 240$

Alex have \$240 more than Kelly.

41) $52.30 + 88.70 = 141.00$

$141 \times 2 = 282$

$282 \div 3 = 94$

$94 \div 5 = 18.80$

Each pair of shoes are \$18.80.

42)a) $2.8 - 1.2 = 1.6$

$1.6 \div 2 = 0.8$

$Q \rightarrow 3 \times 0.8 = 2.4\text{kg}$

The mass of object Q is 1 kg 200g.

b) 400g

43)a) It takes 5 days.

b) 15 days.

44) $2 + 5 = 7$

$210 \div 7 = 30$

$10 \times 30 = 300$

$2 \times 60 = 120$

$10 \times 15 = 150$

$300 + 120 + 150 = 570$

She spent \$570 dollars altogether.